

Submittal: SDWSWH1232Z

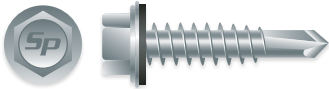

STRONG-POINT[®] UNSLOTTED INDENTED HEX WASHER HEAD, ZINC PLATED W/BONDED NEO-EPDM WASHER

Size	Part#	Pt.	Case Qty.	Description
12-14 x 2	HA1232	3	1.5M	Unslotted Indented Hex Washer Head, Zinc Plated w/Bonded NEO-EPDM Washer
12-14 x 2-1/2	HA1240	3	1M	Unslotted Indented Hex Washer Head, Zinc Plated w/Bonded NEO-EPDM Washer
12-14 x 3	HA1248	3	1M	Unslotted Indented Hex Washer Head, Zinc Plated w/Bonded NEO-EPDM Washer
12-14 x 4	HA1264	3	.5M	Unslotted Indented Hex Washer Head, Zinc Plated w/Bonded NEO-EPDM Washer

Application: Attaches metal to metal.
Drill Capacity (in.): .035 - .210

- Specifications:
- Meets ASTM¹ C 1513 for cold-formed steel framing connections
 - Meets ASTM A 510 for carbon steel manufacturing
 - Manufactured to SAE² J78 for dimensional specifications
 - Meets F.I.P.³-1000.7 for torsional strength and drill speed
 - Meets ASTM F1941 for corrosion resistance
 - ICC-ES Evaluation Report: ESR-3528



Installation: A 5/16" hex nut setter or 5/16" drive socket with torque limiting nose piece set at a maximum of 2000 RPM drive speed recommended. Do not over torque as it can cause the head to snap or stripping of the threads. Installed fasteners must penetrate a minimum of three full threads beyond the metal structure.

Pullout Values (Avg. Lbs.)									
Fastener		Steel Gauge							
Size	Pt.	22	20	18	16	14	12	1/8	3/16
12-14	3	283	333	537	737	1034	1585	2349	2911

Shear Values (Avg. Lbs.)									
Fastener		Steel Gauge (Lapped)							
Size	Pt.	22	20	18	16	14	12	1/8	3/16
12-14	3		749	1320	1574	1914	1929		

The values listed are averages achieved under laboratory conditions and imply no warranty. Appropriate safety factors should be applied to these values for design purposes.

¹(American Society of Testing Materials)

²(Society of Automotive Engineers)

³(Fastener Inspection Products)

HA1232_HA1264_Rev. A (5/27/15)