

Submittal: SDWSWH0820Z

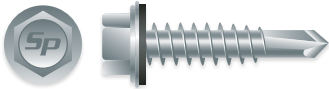

STRONG-POINT[®] UNSLOTTED INDENTED HEX WASHER HEAD, ZINC PLATED W/BONDED NEO-EPDM WASHER

Size	Part#	Pt.	Case Qty.	Description
8-18 x 1-1/4	HA820	2	3M	Unslotted Indented Hex Washer Head, Zinc Plated w/Bonded NEO-EPDM Washer
8-18 x 1-1/2	HA824	2	2.5M	Unslotted Indented Hex Washer Head, Zinc Plated w/Bonded NEO-EPDM Washer
8-18 x 2	HA832	2	2.5M	Unslotted Indented Hex Washer Head, Zinc Plated w/Bonded NEO-EPDM Washer

Application: Attaches metal to metal.
Drill Capacity (in.): .035 - .100

- Specifications:
- Meets ASTM¹ C 1513 for cold-formed steel framing connections
 - Meets ASTM A 510 for carbon steel manufacturing
 - Manufactured to SAE² J78 for dimensional specifications
 - Meets F.I.P.³-1000.7 for torsional strength and drill speed
 - Meets ASTM F1941 for corrosion resistance

Installation: A 1/4" hex nut setter or 1/4" drive socket with torque limiting nose piece set at a maximum of 2500 RPM drive speed recommended. Do not over torque as it can cause the head to snap or stripping of the threads. Installed fasteners must penetrate a minimum of three full threads beyond the metal structure.

Pullout Values (Avg. Lbs.)									
Fastener		Steel Gauge							
Size	Pt.	22	20	18	16	14	12	1/8	3/16
8-18	2	260	292	479	685	933	1533		

Shear Values (Avg. Lbs.)									
Fastener		Steel Gauge (Lapped)							
Size	Pt.	22	20	18	16	14	12	1/8	3/16
8-18	2	546	721	1031	1049				

The values listed are averages achieved under laboratory conditions and imply no warranty. Appropriate safety factors should be applied to these values for design purposes.

¹(American Society of Testing Materials)

²(Society of Automotive Engineers)

³(Fastener Inspection Products)