

Submittal: NPWSW0808Z

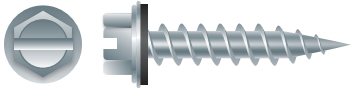

STRONG-POINT[®] SLOTTED INDENTED HEX WASHER HEAD, ZINC PLATED W/BONDED NEO-EPDM WASHER

Size	Part#	Case Qty.	Description
8 x 1/2	NA808	5M	Slotted Indented Hex Washer Head, Zinc Plated w/Bonded NEO-EPDM Washer
8 x 3/4	NA812	5M	Slotted Indented Hex Washer Head, Zinc Plated w/Bonded NEO-EPDM Washer
8 x 1	NA816	4M	Slotted Indented Hex Washer Head, Zinc Plated w/Bonded NEO-EPDM Washer
8 x 1-1/2	NA824	3M	Slotted Indented Hex Washer Head, Zinc Plated w/Bonded NEO-EPDM Washer
8 x 2	NA832	2M	Slotted Indented Hex Washer Head, Zinc Plated w/Bonded NEO-EPDM Washer
8 x 3	NA848	1.5M	Slotted Indented Hex Washer Head, Zinc Plated w/Bonded NEO-EPDM Washer

Application: Attaches light gauge sheet metal to sheet metal or wood.

- Specifications:**
- Meets ASTM¹ A 510 for carbon steel manufacturing
 - Meets ASTM B 633 for electrodeposited zinc coatings
 - Meets ASTM F1941 for corrosion resistance

- Features:**
- Multipurpose sheet metal screw for light to medium gauge applications
 - 22° point pierces light gauge metal
 - Twin fast thread design creates faster installation speeds
 - Bonded washer creates leak proof seal

Installation: A 1/4" hex nut setter or 1/4" drive socket with torque limiting nose piece set at a minimum of 1400 RPM drive speed recommended. Do not over torque as it can cause the head to snap or stripping of the threads. Installed fasteners must penetrate a minimum of three full threads beyond the metal structure.

¹(American Society of Testing Materials)